



SINESENTINEL

Sine Sentinel - 25 kA/mode



4025 Series DIN Option

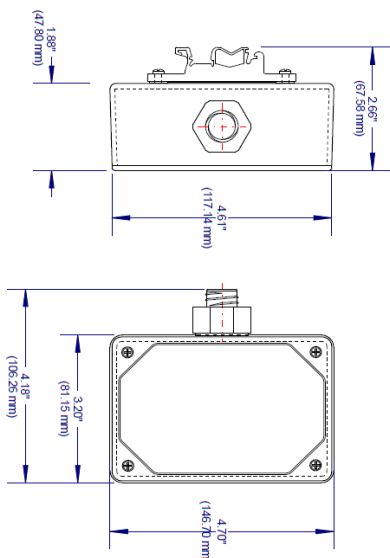

Application: The **x025 Series** is a versatile and effective surge protective device (SPD) designed especially for cost sensitive applications. This SPD is intended for sensitive (filtering option) and critical load applications at branch panels, control panels, and individual equipment disconnects.

ANSI/IEEE C62.41.1 & C62.41.2-2002 environments: Suitable for Categories: A, B & C

Applicable Standards: IEC 61643-11 - Type 2; AS/NZS 1768:2007; ANSI/UL 1449; CSA C22.2 NO. 269.2-13

Circuit Topology: Parallel configured with **Electrical Filtering (optional)** and **MOV Surge Suppression circuitry** incorporating individual component safety disconnecting technology.

Protection Styles: Four (4) (4-mode device considering a 3-phase WYE power supply) or **Seven (7)** (7-mode device considering a 3-phase WYE power supply)

Input Power: 47-62 Hz

TOV Withstand (220v) : 1.45

Voltage Protection Level: $U_p < 800v$

Temperature Rating:

- 40° to 65° C (-40° to 149° F) NEMA 1 (IP50)
- 40° to 80° C (-40° to 185° F) NEMA 4X (IP65)

Enclosure: NEMA 1 Rated Enclosure (standard); NEMA 4X available as an option (add "X" suffix); polymer

Nominal Discharge Current (I_n) Rating: 10 kA

Maximum Discharge Current (I_{max}): 25 kA mode/phase 4 - mode. 25 kA mode/ 50kA phase – 7 mode.

Diagnostics: One Green LED = Good; One Red LED = replace

Short Circuit Current Rating: 25 kA

Connection: 12 AWG (4 mm²) for the 4025 series; and 10 AWG (6 mm²) for the 7025 series stranded wire, 18 in. (457 mm)

Conduit Fitting: 4025 Series ½" fitting; 7025 series ¾" fitting; for flexible conduit (user provided)

Warranty: Five (5) Years

Voltage Code	Circuit Type (Nominal Voltage Shown)	Peak Surge Current (I _{max}) (per mode)	MCOV	ANSI/IEEE C62.41.1™-2002, C62.41.2™-2002, C62.45™-2002, and C62.62™-2010 Measured Limiting Voltages (tested with 6 inches of lead length external to the enclosure per Clauses 6.1.1 of C62.62™-2010 and 37.4.4 of ANSI/UL 1449)		
				Test Mode	Cat A, 30 Ω 100 kHz Ring Wave 2 kV / 67 A @ 270° Phase Angle (filtering option values)	Cat C (6kV/3kA Combination Wave)
1P1	120 V 1φ (2 wire + ground)	25 kA L-N 25 kA L-G 25 kA N-G	150 V 150 V 150 V	L-N L-G N-G	< 40 Vpk < 600 Vpk < 450 Vpk	< 491 Vpk < 990 Vpk < 606 Vpk
1P2	240 V 1φ (2 wire + ground)	25 kA L-N 25 kA L-G 25 kA N-G	320 V 320 V 320 V	L-N L-G N-G	< 34 Vpk < 1168 Vpk < 792 Vpk	< 754 Vpk < 1415 Vpk < 995 Vpk
1R1 (common USA Residence)	120/240 V 1φ (Split) (2 wire + ground)	25 kA L-G 25 kA N-G	150 V 150 V	L-G N-G	< 600 Vpk < 450 Vpk	< 443 Vpk < 653 Vpk
1S1	120/240 V 1φ (Split) (3 wire + ground)	25 kA L-N 25 kA L-G 25 kA N-G	150 V 150 V 150 V	L-N L-G N-G	< 40 Vpk < 600 Vpk < 450 Vpk	< 491 Vpk < 990 Vpk < 606 Vpk
3Y1	208Y/120 V; 3φ Wye (4 wire + ground)	25 kA L-N 25 kA L-G 25 kA N-G	150 V 150 V 150 V	L-N L-G N-G	< 40 Vpk < 600 Vpk < 450 Vpk	< 491 Vpk < 990 Vpk < 606 Vpk
3Y2	480Y/277 V; 380Y/220 V; 400Y/230 V 3φ Wye (4 wire + ground)	25 kA L-N 25 kA L-G 25 kA N-G	320 V 320 V 320 V	L-N L-G N-G	< 34 Vpk < 1168 Vpk < 792 Vpk	< 754 Vpk < 1418 Vpk < 995 Vpk
3N4	480 Δ; 3φ Delta (3 wire + ground)	25 kA L-G 25 kA N-G	550 V 550 V	L-G L-L	< 1332 Vpk < 55 Vpk	< 838 Vpk < 2298 Vpk

Measured Limiting Voltage (MLV) Test Parameters: Positive polarity, Category A: Line power applied, Category C: No line power applied, Voltages are peak (±10%). Measured Limiting Voltages are measured from the insertion point on the sine wave to the peak of the surge for powered tests. Each phase is the average of the modes within that mode of protection. In order to duplicate the results, the specified mode of protection must be tested in all modes (except N-G) and averaged together. (Individual mode or shot results may vary by more than 10%. Scope Settings: Time Base = 10 microseconds per division, Sampling Rate = 2.5 Gigasamples/sec, Bandwidth = 400 MHz (200 MHz for Cat C), Probes: Tektronix P5100/P6015A. These settings help to assure MLV results are accurate). **All tests performed with 6" lead length (external to the enclosure), simulating actual installed performance.**

†Category C High, 10 kA is equivalent to the MLV recorded during the Nominal Discharge Current (I_n) Test from C62.62™-2010 and ANSI/UL 1449.

Model Numbering Legend

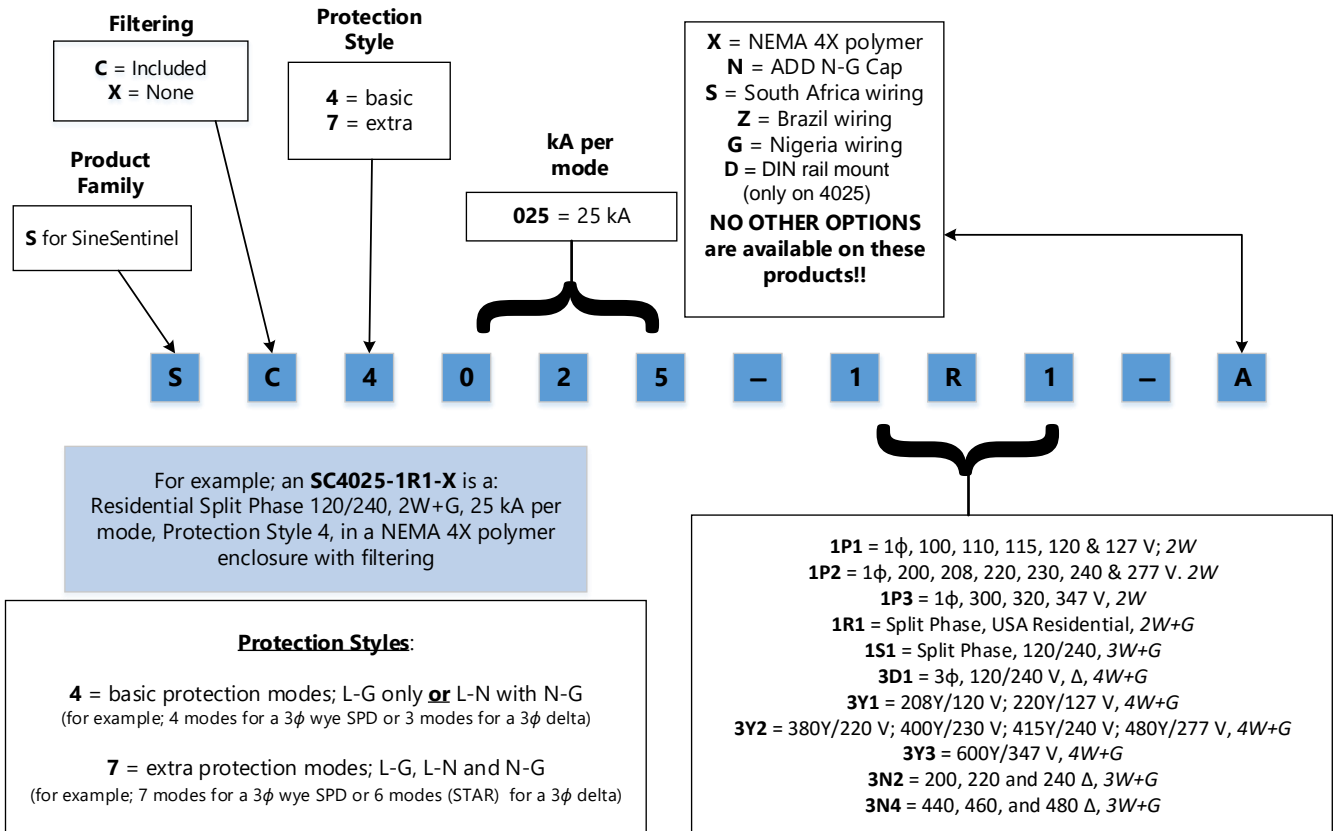

NEMA1 (IP50) – 4025 series

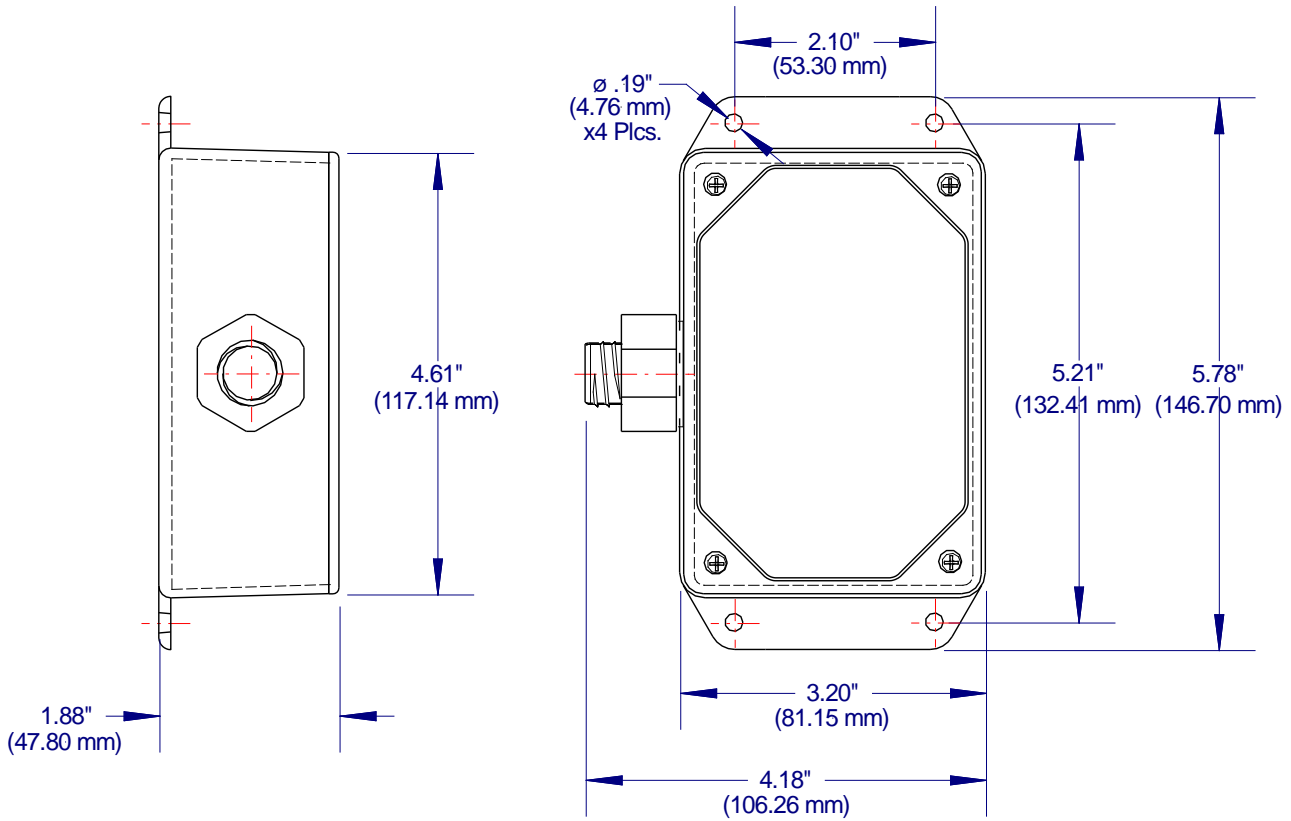

NEMA1 (IP50) – 7025 series

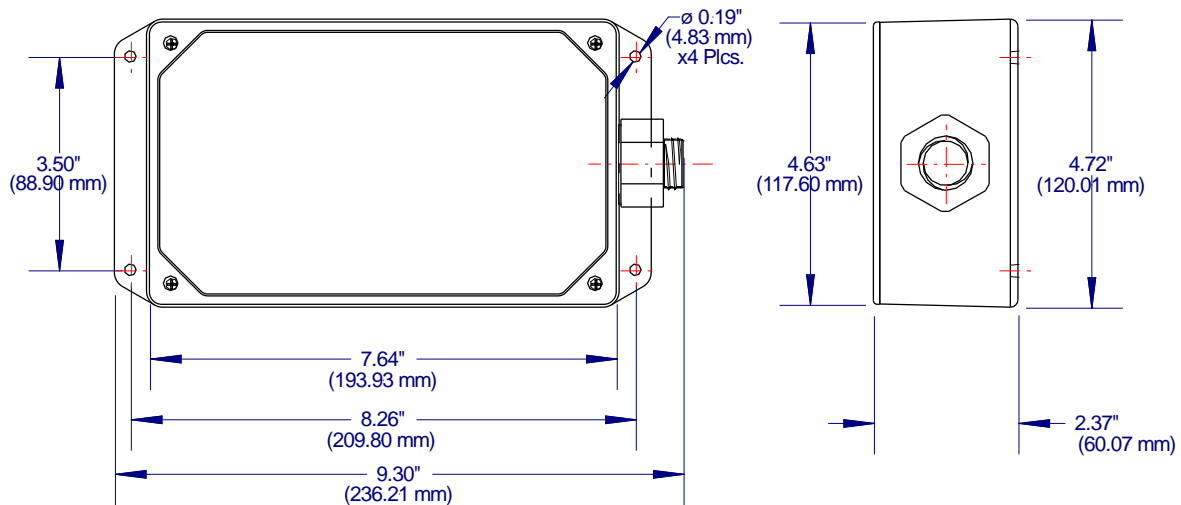

Because we are constantly seeking to improve our products, specifications are subject to change at any time. Photos are without obligation.
© 2015 ECS International Inc.

NEMA4 (IP65) X option - 4025 series

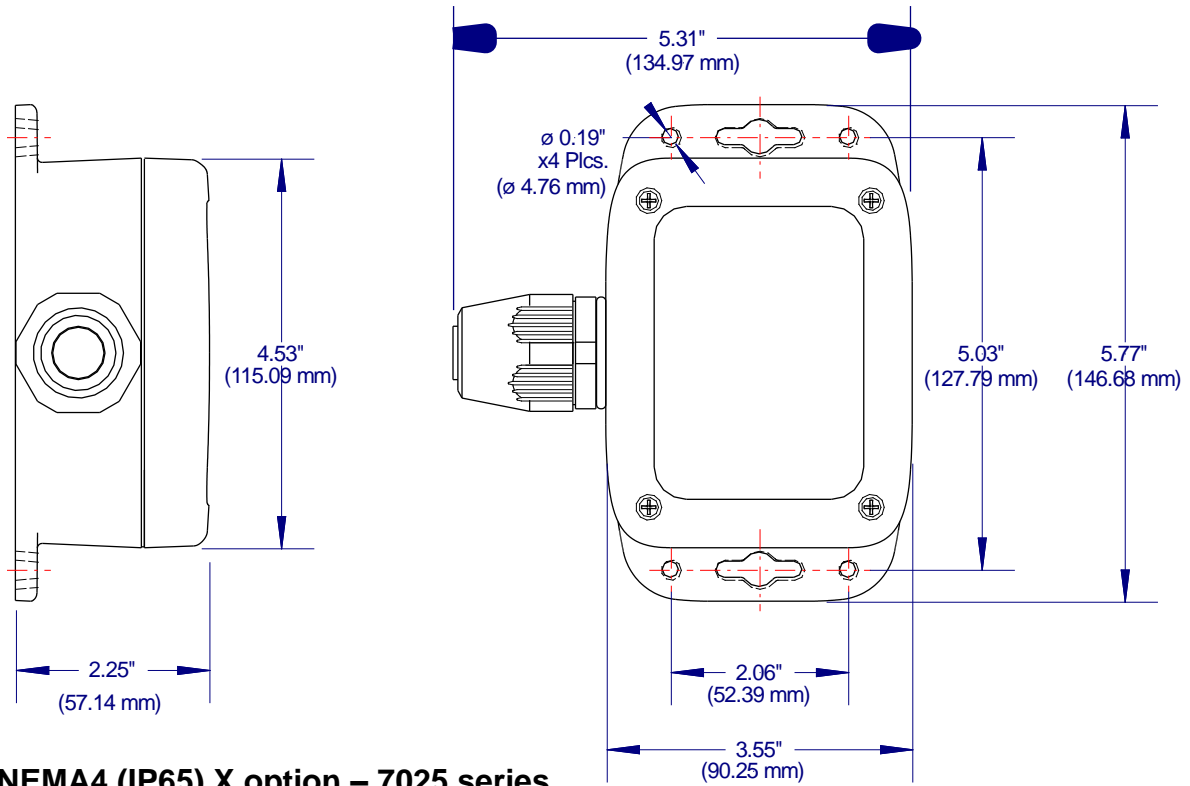

NEMA4 (IP65) X option - 7025 series

